

W10 拖链-安装尺寸及技术参数

W10 Cable Chain-Installation Dimensions and Technical Parameters

架空长度

Unsupported length

- L_G = 直线架空长度
- L_A = 安全塌腰架空长度
- L_G = Unsupported with straight upper run
- L_A = Unsupported with permitted sag

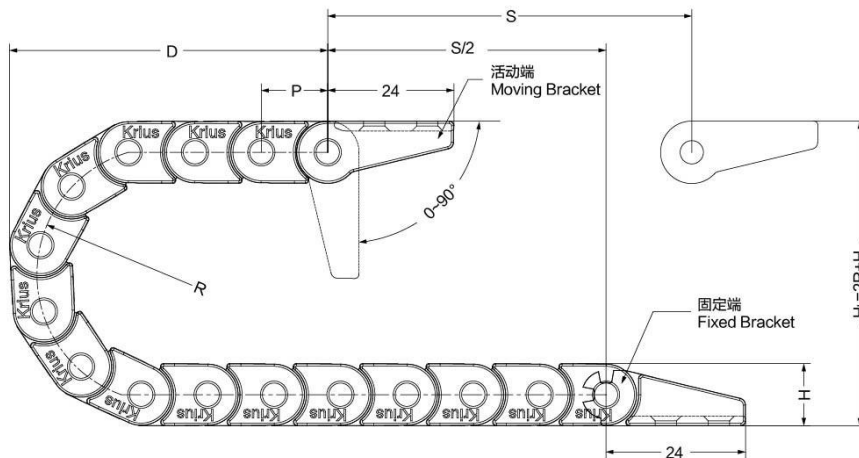
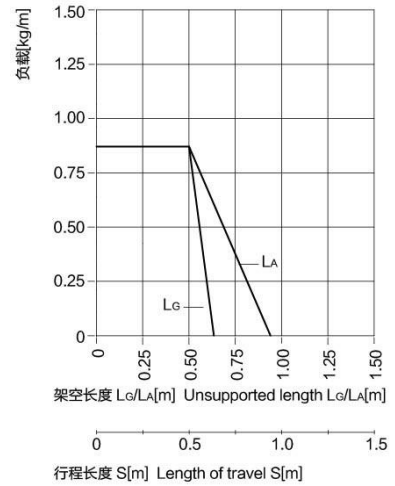
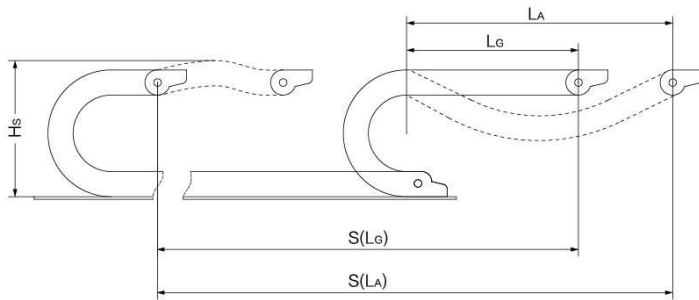

- S = 行程长度
- R = 弯曲半径
- P = 节距
- L = 拖链长度
- N = 每米链节数
- H_L = 理论安装高度
- H_s = 实际安装高度
- D = 拖链退回极限位置时的最小距离
- K = $\pi \cdot R + 2P$
- * K值可在科瑞斯相关表格中直接查询
- S = Length of travel
- R = Bending Radius
- P = Pitch
- L = Length of chain
- N = Links per meter
- H_L = Nominal clearance height
- H_s = Required clearance height
- D = Overlength Energy Chain radius in final position
- K = $\pi \cdot R + 2P$
- * You can find it from below chart for more details

R	H _L	D	K	P
mm (in.)	mm (in.)	mm (in.)	mm (in.)	mm (in.)
18 (0.71)	50 (1.97)	46 (1.81)	80 (3.15)	13 (0.51)

实际安装高度: $H_s = H_L + 10\text{mm}$
拖链长度: $L = S/2 + K$
每米链节数: $N = 77$ (1000mm)

The required clearance height: $H_s = H_L + 0.39\text{in.}$
Chain length: $L = S/2 + K$
Links per meter: $N = 77$ (39.37 in.)

技术参数 Technical Parameters		
速度/加速度 L_G	Speed/acceleration L_G	max.25[m/s]/max.205[m/s ²]
速度/加速度 L_A	Speed/acceleration L_A	max.5[m/s]/max.8[m/s ²]
滑行速度/加速度	Gliding speed/acceleration	max.5[m/s]/max.12[m/s ²]
材料-允许温度 °C	Material-permitted temperature	igumid G/-40°C至+125°C
阻燃等级,igumid G	Flammability Class,igumid G	VDE 0304 IIC UL94 V2

W10 拖链-产品规格范围 W10 Cable Chain-Product specifications

W10拖链-不可打开 W10 Cable Chain-cannot be opened

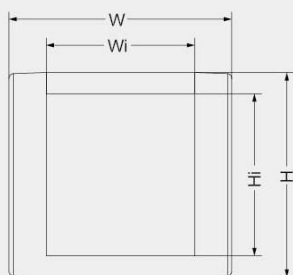

产品代码结构
Part Number Structure

W1010*R*L*n

- 数量 (Quantity)
- 拖链长度 (Length of Cable chains)
- 弯曲半径 (Bending Radius)
- 内宽 (Inner Width)
- 型号 (Type)

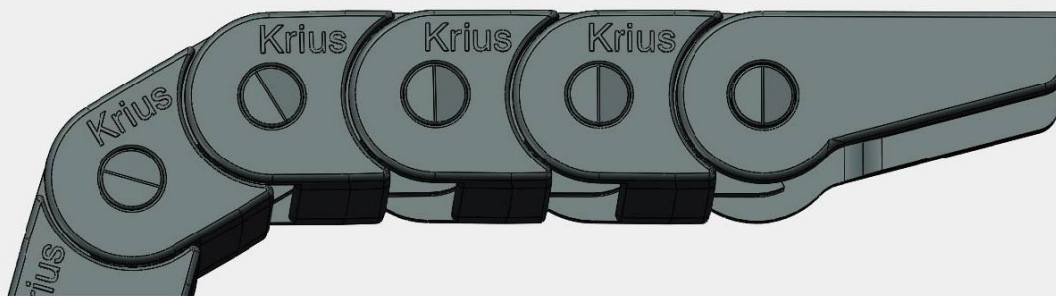

型号 Type	弯曲半径<R> Bending radius	内高<Hl> Inner height	内宽<Wi> Inner width	外高<H> Outer height	外宽<W> Outer Width	重量<G> Weight	备注 Remark
	mm (in.)	mm (in.)	mm (in.)	mm (in.)	mm (in.)	kg/m (lbs/ft)	
W1010		10.4 (0.41)	10.8 (0.43)	14 (0.55)	16.8 (0.66)	0.10 (0.07)	
W1015	15.8 (0.62)		21.8 (0.86)		0.12 (0.08)		
W1020	20.8 (0.82)		26.8 (1.06)		0.14 (0.10)		

订货范例
Order details

W1010 * R18 * 1000mm * 2

R	Hl	D	K	P
mm (in.)	mm (in.)	mm (in.)	mm (in.)	mm (in.)
18 (0.71)	50 (1.97)	46 (1.81)	80 (3.15)	13 (0.51)

W10 拖链-拖链接头 W10 Cable Chain-Mounting Bracket

塑料接头, 整体式 Plastic Mounting Bracket, Integrated type

- 整体式接头
- 耐腐蚀 & 耐摩擦
- 可提供预装配形式
- 可实现内外连接
- Integrated type Mounting Bracket
- Anti-corrosion, Rub-resistance
- Available preassembly form
- Can realize the internal and external connections

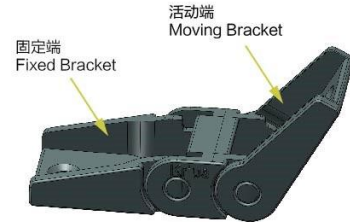

可选配的接头安装方式 Available installation methods

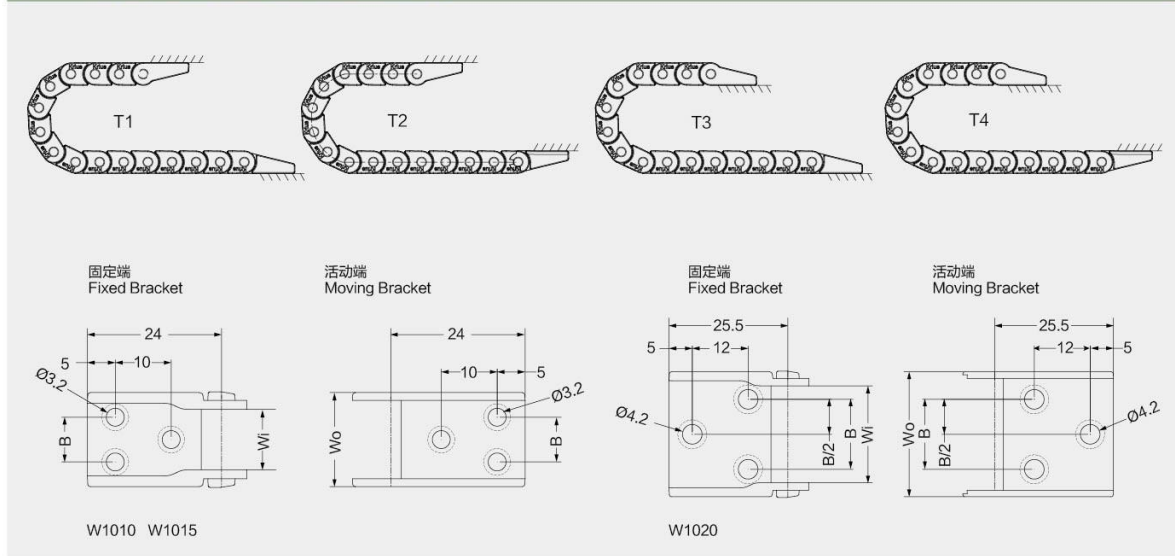

拖链型号 Type	拖链编码 Code	接头编码 Code	Wo尺寸 Dimension Wo mm (in.)	B尺寸 Dimension B mm (in.)
W1010	12230	12231	16.8 (0.66)	8 (0.31)
W1015	12232	12233	21.8 (0.86)	12 (0.47)
W1020	12234	12235	26.8 (1.06)	15 (0.59)

产品代码结构 Part Number Structure

W1010*B*T1



- W1010*B*T1*n 两端接头
On both brackets
- W1010*f*T1*n 固定端接头
Fixed bracket
- W1010*m*T1*n 移动端接头
Moving bracket

★ 每款拖链的接头都有所不同, 订购时如有任何疑问, 请及时咨询科瑞斯。
Every bracket is different, please contact us if you have any question.