

### ZLQ80 拖链-安装尺寸及技术参数

### ZLQ80 Cable Chain-Installation Dimensions and Technical Parameters

#### 架空长度 Unsupported length

- $L_G$  = 直线架空长度
- $L_A$  = 安全塌腰架空长度

- $L_G$  = Unsupported with straight upper run
- $L_A$  = Unsupported with permitted sag

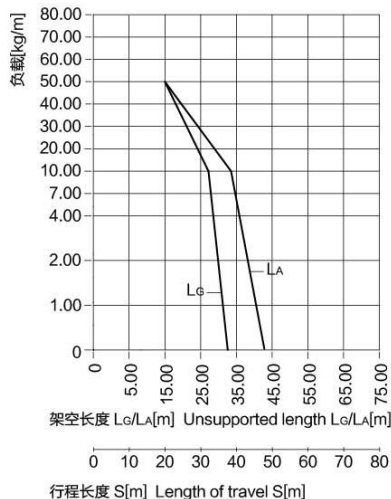
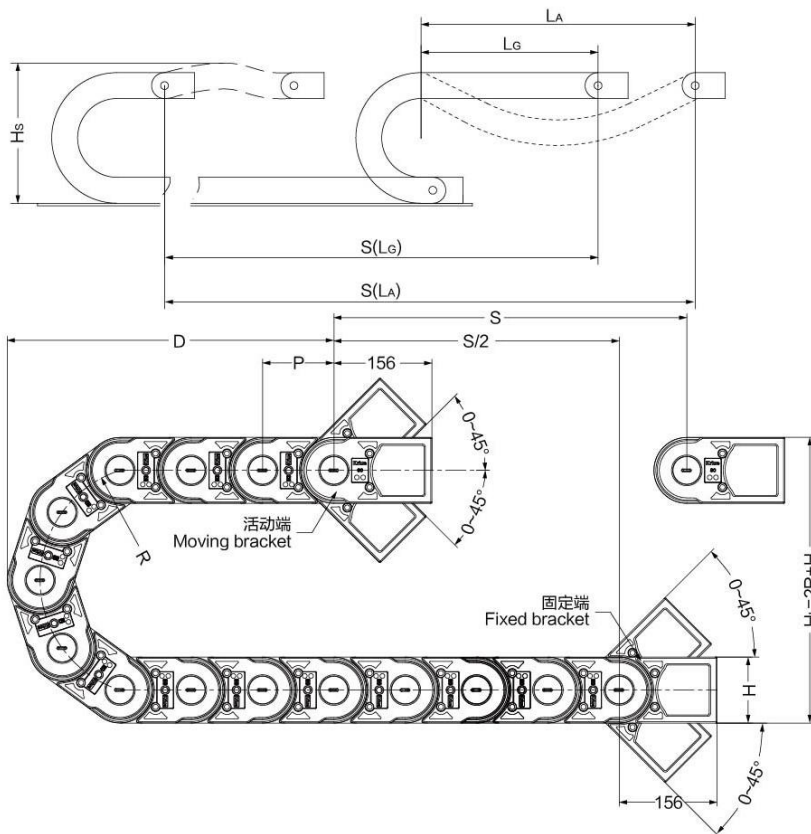

- S = 行程长度
- R = 弯曲半径
- P = 节距
- L = 拖链长度
- N = 每米链节数
- $H_L$  = 理论安装高度
- $H_s$  = 实际安装高度
- D = 拖链退回极限位置时的最小距离
- $K = \pi \cdot R + 2P$
- \* K值可在科瑞斯相关表格中直接查询
- S = Length of travel
- R = Bending Radius
- P = Pitch
- L = Length of chain
- N = Links per meter
- $H_L$  = Nominal clearance height
- $H_s$  = Required clearance height
- D = Overlength Energy Chain radius in final position
- $K = \pi \cdot R + 2P$
- \* You can find it from below chart for more details

R	$H_L$	D	K	P
150 (5.91)	409 (16.10)	310 (12.20)	700 (27.56)	115 (4.53)
200 (7.87)	509 (20.04)	410 (16.14)	860 (33.86)	115 (4.53)
250 (9.84)	609 (23.98)	510 (20.08)	1015 (39.96)	115 (4.53)
300 (11.81)	709 (27.91)	610 (24.02)	1170 (46.06)	115 (4.53)
350 (13.78)	809 (31.85)	710 (27.95)	1330 (52.36)	115 (4.53)
400 (15.75)	909 (35.79)	810 (31.89)	1485 (58.46)	115 (4.53)
500 (19.69)	1109 (43.66)	1010 (39.76)	1800 (70.87)	115 (4.53)
600 (23.62)	1309 (51.54)	1210 (47.64)	2115 (83.27)	115 (4.53)
650 (25.59)	1409 (55.47)	1310 (51.57)	2270 (89.37)	115 (4.53)
1000 (39.37)	2109 (83.03)	2010 (79.13)	3370 (132.68)	115 (4.53)

实际安装高度:  $H_s = H_L + 120\text{mm}$   
 拖链长度:  $L = S/2 + K$   
 每米链节数:  $N = 9$  (1035mm)

The required clearance height:  $H_s = H_L + 4.72\text{in.}$   
 Chain length:  $L = S/2 + K$   
 Links per meter:  $N = 9$  (40.75 in.)

技术参数 Technical Parameters		
速度/加速度 $L_G$	Speed/acceleration $L_G$	max.25[m/s]/max.205[m/s <sup>2</sup> ]
速度/加速度 $L_A$	Speed/acceleration $L_A$	max.5[m/s]/max.8[m/s <sup>2</sup> ]
滑行速度/加速度	Gliding speed/acceleration	max.5[m/s]/max.12[m/s <sup>2</sup> ]
材料-允许温度 °C	Material-permitted temperature	igumid G/-40°C至+125°C
阻燃等级, igumid G	Flammability Class, igumid G	VDE 0304 IIC UL94 V2

## ZLQ80 拖链-产品规格范围 ZLQ80 Cable Chain-Product specifications

ZLQ80拖链-内外侧可开 ZLQ80 Cable Chain-Inner and outer can be opened

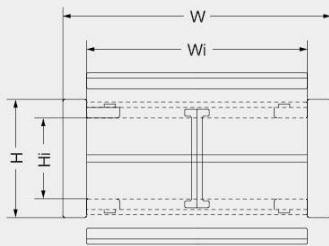

产品代码结构  
Part Number Structure

ZLQ80100\*R\*L\*n

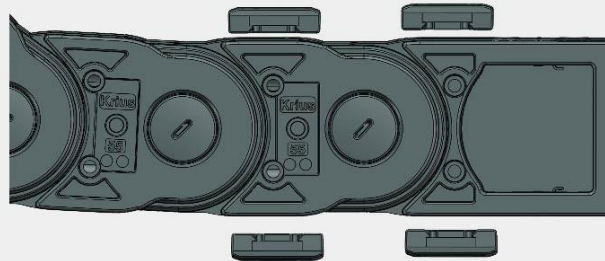

型号 Type	弯曲半径<R> Bending radius	内高<Hi> Inner height	内宽<Wi> Inner width	外高<H> Outer height	外宽<W> Outer Width	重量<G> Weight	备注 Remark
	mm (in.)	mm (in.)	mm (in.)	mm (in.)	mm (in.)	kg/m (lbs/ft)	
ZLQ8075		80 (3.15)	75 (2.95)	109 (4.29)	123 (4.84)	5.72 (3.89)	
ZLQ80100			100 (3.94)		148 (5.83)	6.12 (4.16)	
ZLQ80125			125 (4.92)		173 (6.81)	6.52 (4.43)	
ZLQ80150			150 (5.91)		198 (7.80)	6.93 (4.71)	
ZLQ80175			175 (6.89)		223 (8.78)	7.35 (5.00)	
ZLQ80200			200 (7.87)		248 (9.76)	9.79 (6.66)	
ZLQ80250			250 (9.84)		298 (11.73)	10.35 (7.04)	
ZLQ80300			300 (11.81)		348 (13.70)	11.84 (8.05)	
ZLQ80350			350 (13.78)		398 (15.67)	12.36 (8.40)	
ZLQ80400			400 (15.75)		448 (17.64)	14.02 (9.53)	
ZLQ80450			450 (17.72)		498 (19.61)	15.70 (10.68)	
ZLQ80500			500 (19.69)		548 (21.57)	16.23 (11.04)	
ZLQ80550			550 (21.65)		598 (23.54)	19.22 (13.07)	
ZLQ80600			600 (23.62)		648 (25.51)	21.06 (14.32)	

订货范例  
Order details

ZLQ8075 \* R150 \* 1000mm \* 2

R	Hl	D	K	P
150 (5.91)	409 (16.10)	310 (12.20)	700 (27.56)	115 (4.53)
200 (7.87)	509 (20.04)	410 (16.14)	860 (33.86)	115 (4.53)
250 (9.84)	609 (23.98)	510 (20.08)	1015 (39.96)	115 (4.53)
300 (11.81)	709 (27.91)	610 (24.02)	1170 (46.06)	115 (4.53)
350 (13.78)	809 (31.85)	710 (27.95)	1330 (52.36)	115 (4.53)
400 (15.75)	909 (35.79)	810 (31.89)	1485 (58.46)	115 (4.53)
500 (19.69)	1109 (43.66)	1010 (39.76)	1800 (70.87)	115 (4.53)
600 (23.62)	1309 (51.54)	1210 (47.64)	2115 (83.27)	115 (4.53)
650 (25.59)	1409 (55.47)	1310 (51.57)	2270 (89.37)	115 (4.53)
1000 (39.37)	2109 (83.03)	2010 (79.13)	3370 (132.68)	115 (4.53)

## ZLQ80 拖链-拖链接头 ZLQ80 Cable Chain-Mounting Bracket

### 塑料接头, 分体式 Plastic Mounting Bracket, Splitted structure

- 双侧独立式塑料接头
- 两端接头均可活动
- 耐腐蚀 & 耐摩擦
- 可提供预装配形式
- 可实现内外连接
- Independent Plastic mounting bracket on the two end
- Two end mounting bracket can be movable to upper and lower
- Anti-corrosion, Rub-resistance
- Available preassembly form
- Can realize the internal and external connections

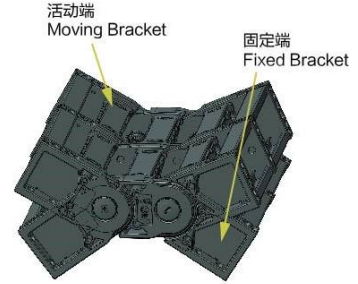

### 可选配的接头安装方式 Available installation methods

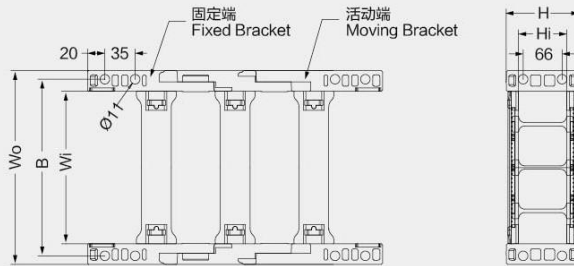
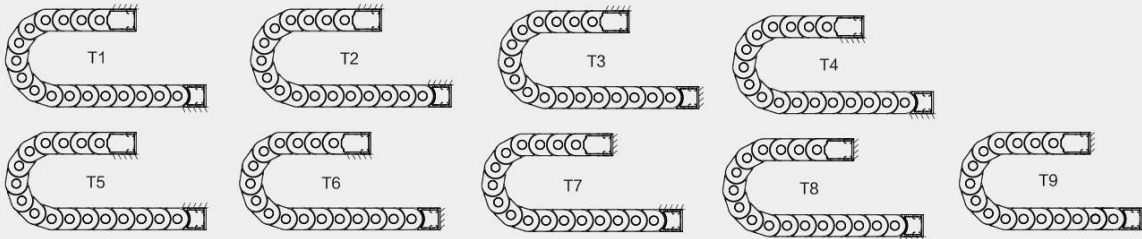

ZLQ8075 / ZLQ80100 / ZLQ80125 / ZLQ80150 / ZLQ80175  
ZLQ80200 / ZLQ80250 / ZLQ80300 / ZLQ80350 / ZLQ80400  
ZLQ80500 / ZLQ80550 / ZLQ80600

拖链型号 Type	拖链编码 Code	其他编码 Other Code	Wo尺寸 Dimension Wo	B尺寸 Dimension B
ZLQ8075	13074		mm (in.)	mm (in.)
ZLQ80100	13075	接头 Mounting Bracket 13150	123 (4.84)	103 (4.06)
ZLQ80125	13076		148 (5.83)	128 (5.04)
ZLQ80150	13077	主体 Separator 13148	173 (6.81)	153 (6.02)
ZLQ80175	13078		198 (7.80)	178 (7.01)
ZLQ80200	13079	竖隔离片 Vertical separator 13152	223 (8.78)	203 (7.99)
ZLQ80250	13080		248 (9.76)	228 (8.98)
ZLQ80300	13093	横隔离片 Horizontal separator 13151	298 (11.73)	278 (10.94)
ZLQ80350	13085		348 (13.70)	328 (12.91)
ZLQ80400	13102	横隔离片 Transverse septum 13087	398 (15.67)	378 (14.88)
ZLQ80450	13103		448 (17.64)	428 (16.85)
ZLQ80500	13103	L400隔离杆 Separator of Length with 400mm 13090	498 (19.61)	478 (18.82)
ZLQ80550	13104		548 (21.57)	528 (20.79)
ZLQ80600	13104	锁扣 Fixed Plate 13092	598 (23.54)	578 (22.76)
			648 (25.51)	628 (24.72)

### 产品代码结构 Part Number Structure

#### ZLQ80100\*B\*T1

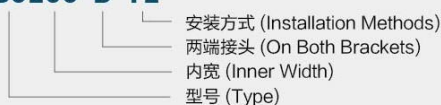

- ZLQ80100\*B\*T1\*n 两端接头  
On both brackets
- ZLQ80100\*f\*T1\*n 固定端接头  
Fixed bracket
- ZLQ80100\*m\*T1\*n 移动端接头  
Moving bracket

★ 每款拖链的接头都有所不同, 订购时如有任何疑问, 请及时咨询科瑞斯。  
Every bracket is different, please contact us if you have any question.



## ZLQ80 拖链-隔离片 ZLQ80 Cable Chain-Separator

- 本款拖链配备的隔离元件为横隔离（插）片和竖隔离（插）片，可以实现垂直分割和水平分隔
- 隔离元件的数量可以根据客户的实际需求进行配备
- 竖隔（插）片可以根据线缆排布进行滑动
- The isolation element is equipped with horizontal chain (plug) and vertical isolation (plug), you can achieve vertical segmentation and horizontal partitioning
- The number of isolated components can be equipped according to the actual needs of customers
- Separator can be moved for different cables

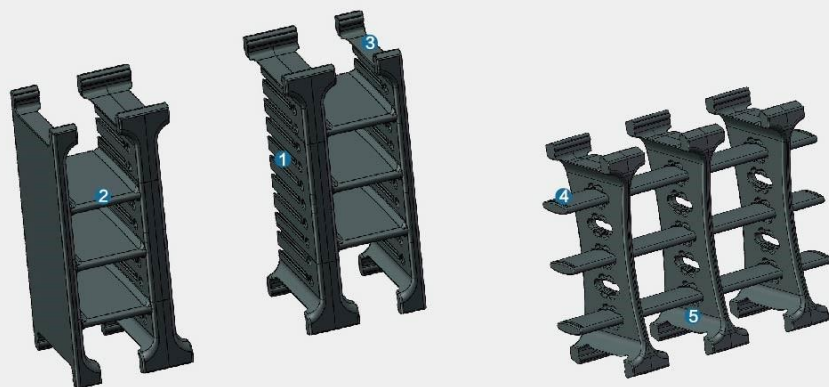
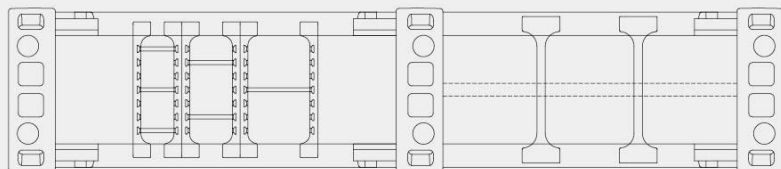

单位: mm

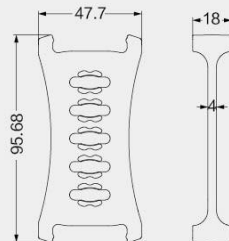
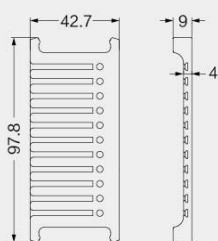
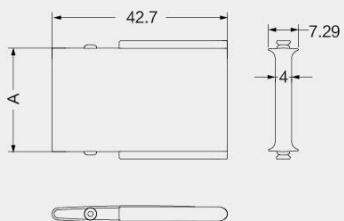
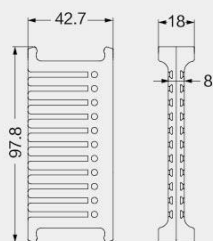

ZLQ80隔离元件编码  
The separator NO. for ZLQ80 :

① 竖隔离片 (Vertical Separator)	13152
② 横隔插片 (Transverse Septum)	13087
③ 竖隔离片 (Vertical Separator)	13152
④ 横隔离片 (Horizontal Separator)	13151
⑤ 竖隔离片 (Vertical Separator)	13152

注: ①②③之间的距离可以为25mm、30mm、40mm、50mm、60mm、70mm  
Note: (1) (2) (3) the distance between the 25mm, 30mm, 40mm, 50mm, 60mm, 70mm